

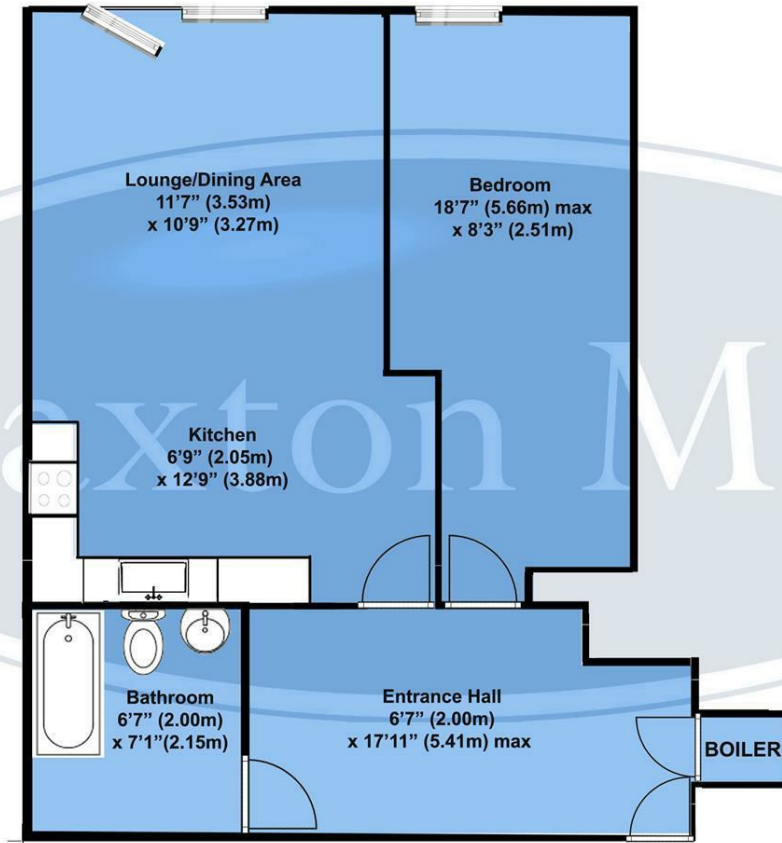

Apt 48 AG1 Furnival Street, Sheffield S1 4QS **£750 Per Calendar Month**

SECURE ALLOCATED PARKING SPACE - Available to let is this contemporary, one bedroom 4th floor apartment. Situated in this exclusive development and located within the city centre, close to the hospitals and universities the accommodation consists of: entrance hallway. Kitchen/living area with modern fitted kitchen, including a range of hi spec appliances including: hob, oven, and fridge/freezer. From the living area there are patio doors leading to a Juliet balcony having roof top views of St Paul's and of the Winter Gardens. Double bedroom and luxury bathroom with power shower over the bath.

Allocated parking included. PART FURNISHED 6 MONTHS TENANCY. Restrictions - No smokers, students, sharers or pets. Energy Efficiency Rating C. Council Tax Band A



Total area: approx. 491.6 sq. feet (45.5 sq metres)
All measurements are approximate

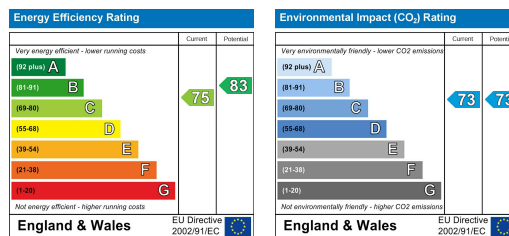

Banner Cross
Hathersage
Bakewell
Matlock
www.saxtonmee.co.uk

949-951 Ecclesall Road, Sheffield S11 8TN
3 Bank View, Main Road, Hathersage S32 1BB
Matlock Street, Bakewell DE45 1EE
27 Causeway Lane, Matlock, DE4 3AR

T: 0114 268 3241
T: 01433 650009
T: 01629 815307
T: 01629 828250

E: bannercross@saxtonmee.co.uk
E: hathersage@saxtonmee.co.uk
E: bakewell@saxtonmee.co.uk
E: matlock@saxtonmee.co.uk